



**TAP**  
ACOUSTICS

Redefining the boundaries of acoustic design.

---

# DIRECTOR'S MESSAGE



**Sumit Mall**

Director - TAP® Acoustics

Welcome to TAP® Acoustics, where we combine cutting edge technology with sustainable materials to deliver exceptional acoustic solutions. Our eco-friendly acoustic panels are crafted with precision and care, ensuring high performance sound absorption for your spaces. We take pride in our craftsmanship and are committed to providing you with exceptional service and products that meet your unique needs.

# CONTENT

---

## Introduction

Acoustic Innovation | Company Overview | Sustainability Certifications | Reach | R&D | Infrastructure | Making of TAP | Why TAP | Aesthetics | Surface Innovations

## Products

Colours | **Walls** | Solid | Groove | 3D | Embossed | Laser **Ceiling** | Grid | Baffle | Floating | Intersecting | **Acoustic Lighting**

## Technical

Technical Info | Physical Specification | Technical Specification | Declare | 9mm Panel | 12mm Panel | 24mm Panel | Specification Know-How | Connect With Us

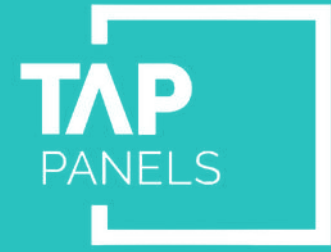

# INTRODUCTION

---

# ACOUSTIC

## INNOVATION



We are dedicated to pushing the boundaries of acoustic design and technology. Our relentless focus on innovation allows us to create solutions that **go beyond the traditional sound-absorbing materials**, resulting in a truly unique acoustic experience.

Our commitment to acoustic innovation starts with our team of experts. With years of experience in acoustic engineering, our team brings a deep understanding of sound and its interaction with our environment. This expertise allows us to develop products that not only absorb sound, but also **enhance the acoustic environment, creating a more peaceful and productive space.**

But we don't stop there. With TAP®, we're constantly **exploring new materials, textures, and finishes** that can elevate the acoustic experience even further.

Our dedication to innovation doesn't just benefit our clients - it also drives us to be **more sustainable and eco-friendly.** By utilizing the latest materials and technologies, we're able to create products that are not only high-performing, but also better for the environment.

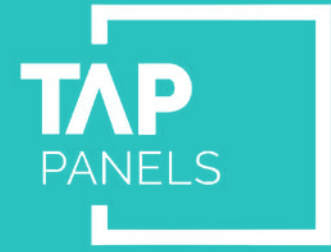

Good acoustics is like a great meal, it should nourish your senses and leave you satisfied.

# COMPANY

## OVERVIEW

TAP® Acoustics is a leading brand of Times Fibrefill Pvt. Limited, a family-owned business that has been **established since 2001**. With over **200 employees across four locations**, Times Fibrefill is dedicated to providing **high-quality and sustainable solutions** to its customers. The company's dedication to excellence and customer satisfaction has led it to **export products to over 15 countries worldwide**, making it a trusted provider of innovative acoustic solutions.



# SUSTAINABILITY

---

At TAP® Acoustics, **sustainability is at the core of everything we do. We have been committed to sustainable design and manufacturing from the very beginning**, long before it became a global necessity.

It is a fundamental part of our identity, not just a mere aspect of our operations. As pioneers in high-performance acoustic finishes and textiles, **we take pride in using recycled materials, predominantly post-consumer PET plastic**, to make a direct contribution towards achieving a circular economy.

With the alarming amount of plastic waste generated globally each year, we at **TAP® Acoustics recognize the importance of finding innovative ways to reuse and upcycle this waste**. Our commitment to sustainability is evident in our use of recycled materials to create value-added resources that meet growing market demand for interior finishes.

By using post-consumer PET plastic waste, **we are not only reducing the amount of plastic waste that ends up in landfills and oceans, but also promoting a sustainable future for generations to come**.



**1800 Tonnes**

Plastic Bottles Recycled  
to Make Acoustic  
Products



**120 Million**

600ml Plastic Bottles  
Diverted from Landfills  
& Waterways

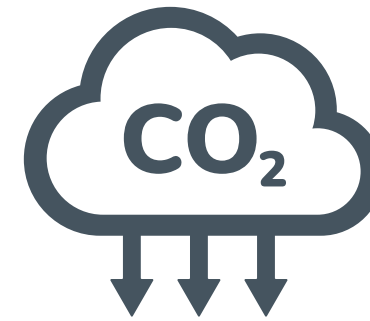

**900 Tonnes**

reduced CO<sub>2</sub> emissions  
by R-PET



**130 Million**

Black Balloons Filled  
with Carbon Pollution  
Prevented from  
Warming Our Planet

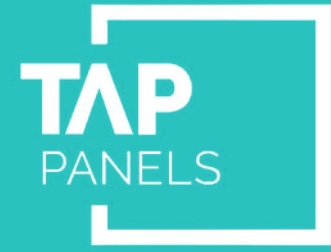

By 2030, we will reduce our greenhouse gas emissions by 50% whilst maintaining a positive social impact.

# CERTIFICATIONS

## GREEN PRO

GreenPro Ecolabel is **accredited by Global Ecolabelling Network (GEN) through GENICES – GEN's Internationally Coordinated Ecolabelling System**. Our product, TAP Panel, which bears GreenPro Ecolabel has lower environment impact and contributes significantly for **enhancing the performance of Green Buildings and Green Companies**. GreenPro empowers end users with product sustainability information and steer them towards purchasing of sustainable products.

## GRS

Our commitment to proving our green footprint and mapping the **supply chain ensured that we become GRS certified**.

The Recycled Claim Standard (RCS) and Global Recycled Standard (GRS) are **international, voluntary standards that set requirements for third-party certification of recycled input** and chain of custody. The shared goal of the standards is to increase the use of recycled materials. The GRS includes additional criteria for social and environmental processing requirements and chemical restrictions.

TAP® is a **leading Indian brand with a widespread presence across various states**. The brand's top-notch production facilities are located in Kolkata, West Bengal, where we operate a fully automated, **state-of-the-art plant equipped with the latest machinery to ensure top-quality production**.

TAP's strategic focus is on specific high-potential and high value markets, which we serve through a **well-established sales network covering the entire country**. This targeted approach has enabled the brand to establish a solid reputation in the industry and gain the trust of customers who value quality and efficiency.

# REACH

---



Manufacturing



Supply

# RESEARCH & DEVELOPMENT

---

Our in-house R&D Lab is focused on developing high-quality acoustic products that meet relevant building standards. To achieve this, we use **state-of-the-art equipment, including an Impedance Tube, which is the standard device for measuring Sound Absorption Coefficient ( $\alpha$ ) as per ISO 10534-2 and Transmission Loss (TL) as per ASTM E2611** over all audible frequencies.

In addition to our acoustic testing capabilities, we also have the **ability to verify the colours of our TAP® Panels using world standard PANTONE or RAL Colour Kits**. We take great care to ensure that different lots are compared to each other, and variations are compared on a Newton Colour Disc to ensure standardisation within different lots.

To further ensure colour accuracy, we **utilise industry standard colour matching cabinets to check for variations under a standard light source**. This ensures that our TAP® Panels not only meet high standards of acoustic performance but also maintain consistent and accurate colours across different lots.

# INFRASTRUCTURE & MANUFACTURING

Our manufacturing infrastructure is designed to **produce high-quality TAP® Panels with efficiency and consistency.** With the **capacity to manufacture up to 1 million Sq. Ft. per month**, we can cater to large-scale projects while also offering customisations for small orders.

Our range of fibres allows us to tailor the acoustic and thermal insulation properties of our products, while the **ability to mix up to three different colours produces homogeneous products with consistent colours.** We offer finishes such as water and oil repellent treatments, anti-microbial and anti-viral finishes, and ultra-high flame retardant properties.

We have advanced **value-addition machines, including CNC Digital Cutters, CO2 Laser-Cutting Machine, UV Digital Printing Machine, Pressure-Forming Machine, and Vacuum Forming Machine**, which enable us to manufacture high quality TAP® with precision and quality to meet specific project requirements.





# MAKING OF TAP



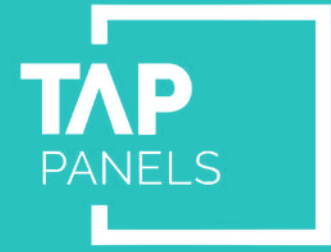

**TAP® Panels are a result of a global effort for increasing usage of sustainable building materials made from post consumer recycle waste.**



Soft drink & detergent bottles made from PET identified by and collected from customers.

Contaminants like lids & sticky labels are removed. Bottles are chipped into tiny pellets.

Pallets are washed and sanitised.

Pallets and colour are fed into a hopper. A heater at the base of the hopper melts the pallets to form a free flowing resin.

Resin is pumped through a sophisticated shower - a rose device known as a spinneret.

Cold air fans 'set' the fine fibres extruded from the spinneret.

Fibres are drawn and cut and blended into a web.

Contaminants like lids & sticky labels are removed. Bottles are chipped into tiny pellets.

Acoustic panels can be further used to create design patterns such as embossed, groove, etc.

## Product Life Cycle

---

# WHY TAP



## **Enhanced Acoustics**

Engineered to provide superior acoustic performance, effectively reducing noise levels and creating a more comfortable environment.

## **Innovative Design**

With sleek and innovative design, TAP® Panels blend seamlessly with any interior space while adding a touch of elegance to it.

## **Fire Retardant**

Designed to prioritise safety, with ultra-high flame retardant properties which exceed American, European, and Indian fire safety regulations and make them a reliable choice for any space.

# WHY TAP



## **Tailored Customisation**

Customisation is at the heart of TAP®. With a range of options for size, colour, texture, fabric-wrapping and printing, we can create a bespoke acoustic solution that fits your needs.

## **Longevity & Sturdiness**

Unique, light-weight and compressed fabric-like surface provides a self finishing solution that is both durable and long lasting, and requires minimal maintenance.

## **Hassle-Free Application**

Allows for effortless installation. Easy to cut, install and paste and can also be mounted/suspended from ceiling with the help of suitable mechanisms to suit different project needs.



# AESTHETICS

---





# AESTHETICS

---

TAP® Panels are more than just functional pieces - they are also stunning works of art. Through **our consistent R&D, we are able to create a range of textures and designs that can be customized to blend seamlessly with any interior space.** With our commitment to superior aesthetics, our panels provide a sophisticated and contemporary touch that elevates any space. From **classic and timeless designs to bold and modern ones, TAP® Panels offer a versatile and tailored solution for any acoustic needs while adding a stylish accent to your space.**

# SURFACE INNOVATIONS

---





# SURFACE

## INNOVATIONS

---

Our approach to research and development of TAP® Panels is rooted in our commitment to design excellence. We strive to **create surface patterns, prints, and 3D moulded structures that not only optimize aesthetics but also provide an immersive touch and feel experience.** Although the product finish is carpet-like, it can be compressed to give a seamless finish. Moreover, the versatility of our **TAP® panels allows for customization according to our clients' preferences - they can be fabric-wrapped or wooden laminated,** providing a range of options to choose from.



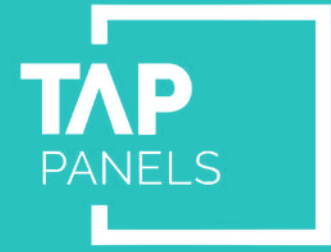

# PRODUCTS

---

# COLOURS

---

TAP® Panels come in an **extensive range of 36 standard colours, meticulously curated to perfectly match the most commonly used wall paint shades.** This allows for effortless blending and mixing, enabling our clients to create a seamless, cohesive look in any interior space.

However, we understand that every project is unique and our clients' preferences may extend beyond the standard colour palette. To ensure that our clients receive exactly what they envision, **we offer customization options with a plethora of colours to choose from.**



CREAM

LIGHT BEIGE

BEIGE

NATURAL BEIGE

STONE BEIGE

DARK BEIGE

JUTE

BROWN

CHOCOLATE  
BROWN

**BEIGE**  
& BROWN

---



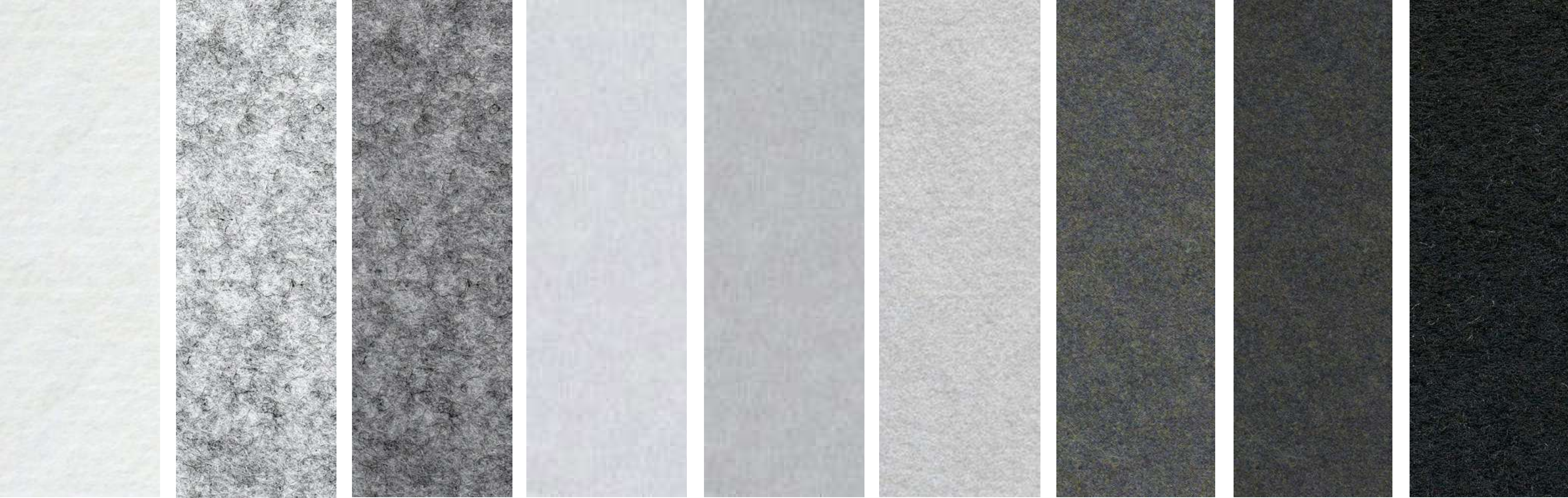

WHITE

MELANGE

DARK MELANGE

SLATE GRAY

GRAY

NATURAL GRAY

STONE GRAY

ASH GRAY

BLACK

**BLACK**  
GREY & WHITE

---



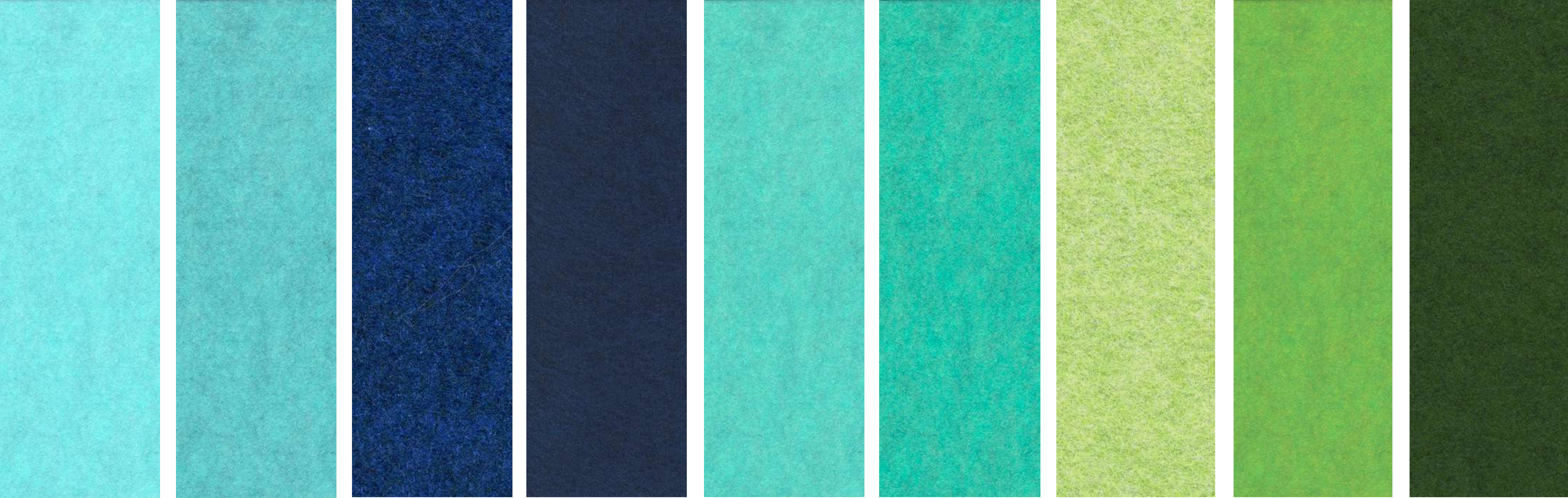

WHITE

SKY BLUE

ROYAL BLUE

NAVY BLUE

TURQUOISE

TEAL

GRASS GREEN

STONE GREEN

URBAN GREEN

**BLUE**  
& GREEN

---



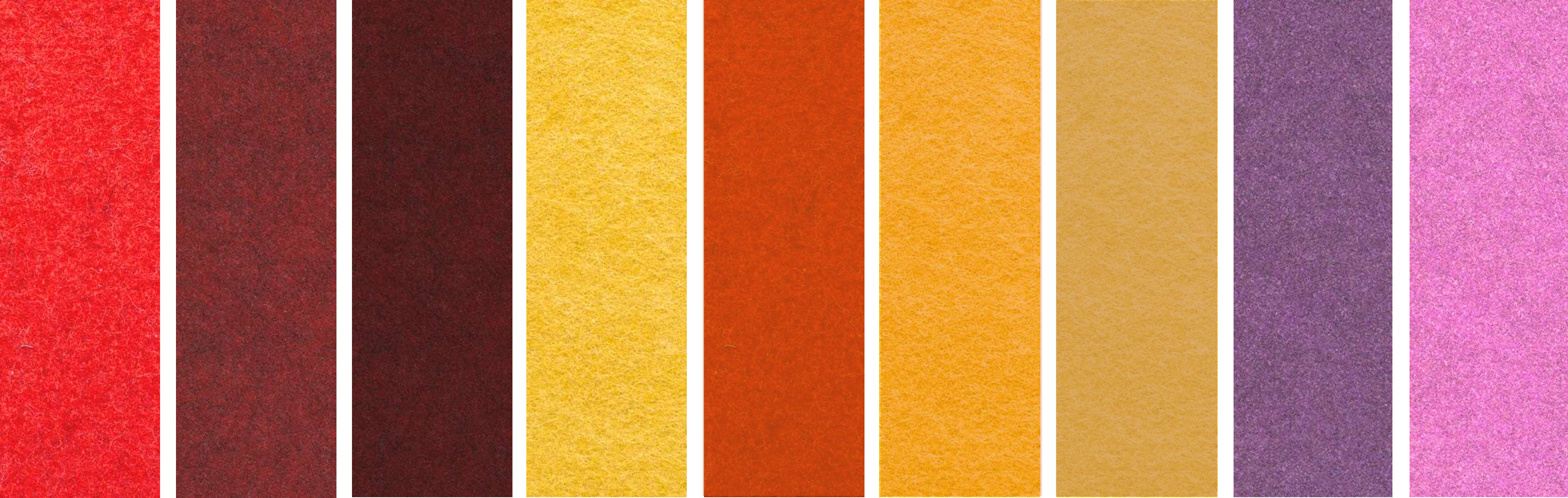

RED

MAROON

DARK MAROON

YELLOW

ORANGE

GOLD

MUSTARD

PURPLE

PINK

# RED

YELLOW & ORANGE





# WALLS

---

TAP® Panels are a game-changer for wall panelling, offering a multitude of design options to suit any style. Whether you prefer a solid, textured, or 3D effect, TAP® can bring your walls to life. **With a range of finishes, from smooth to embossed, we can help you create a dynamic look that complements your decor.** Whether you want a bold statement piece or a subtle accent, TAP® is the perfect solution for adding depth, texture, and visual interest to any room, while maintaining the superior acoustics.

**SOLID**





TAP® Solid Series is an innovative product range that delivers exceptional noise control, with absorption of at least 85% of sound energy. With a sturdy compressed face, TAP® Solid panel is available as 8ft by 4ft sheet and can be cut into any size or shapes to meet your design requirements.

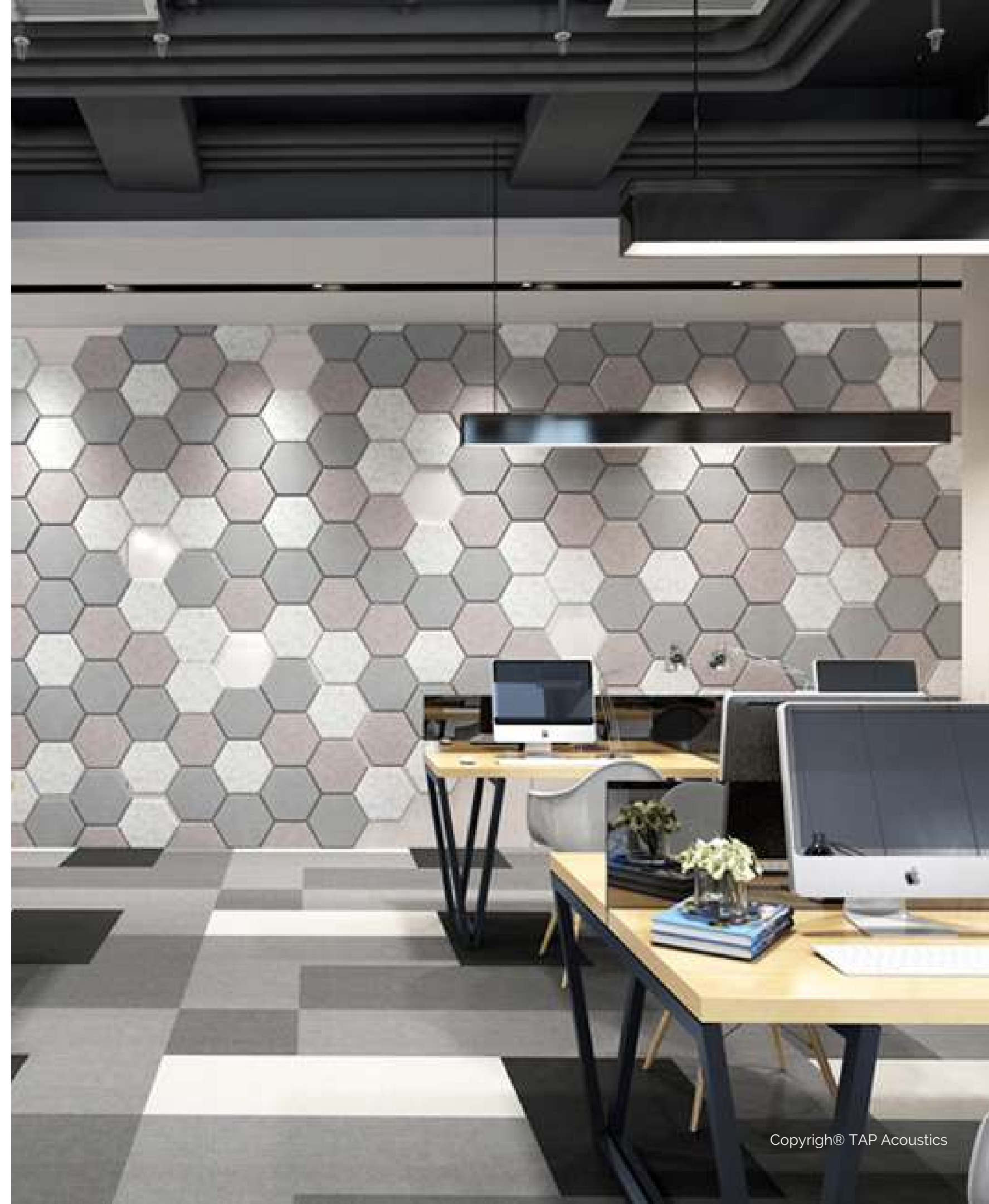



GROOVE





Tactful design is the one where form meets functionality, and functionality meets aesthetics - TAP® Groove Series customisation allows you to explore the world of acoustics in a way that goes beyond subtle patterns - adding nuance, texture and depth to an interior space.





VERTICAL



SQUARES



OVAL

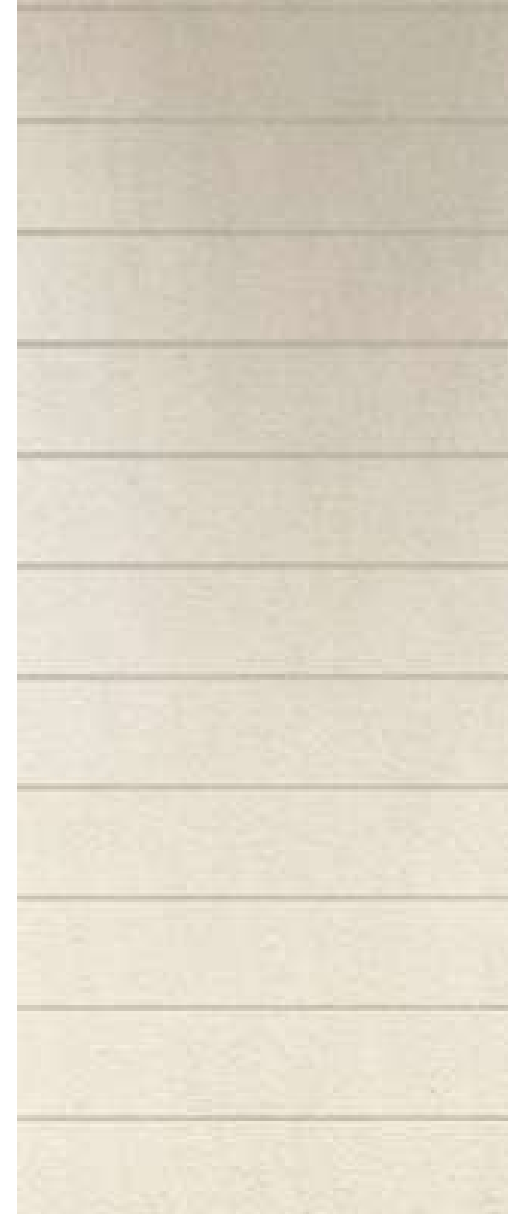

HORIZONTAL



DIAGONAL



CHECKERED



CIRCULAR

# GROOVE

PATTERNS

[Use 3D Style Selector](#)



Vertical



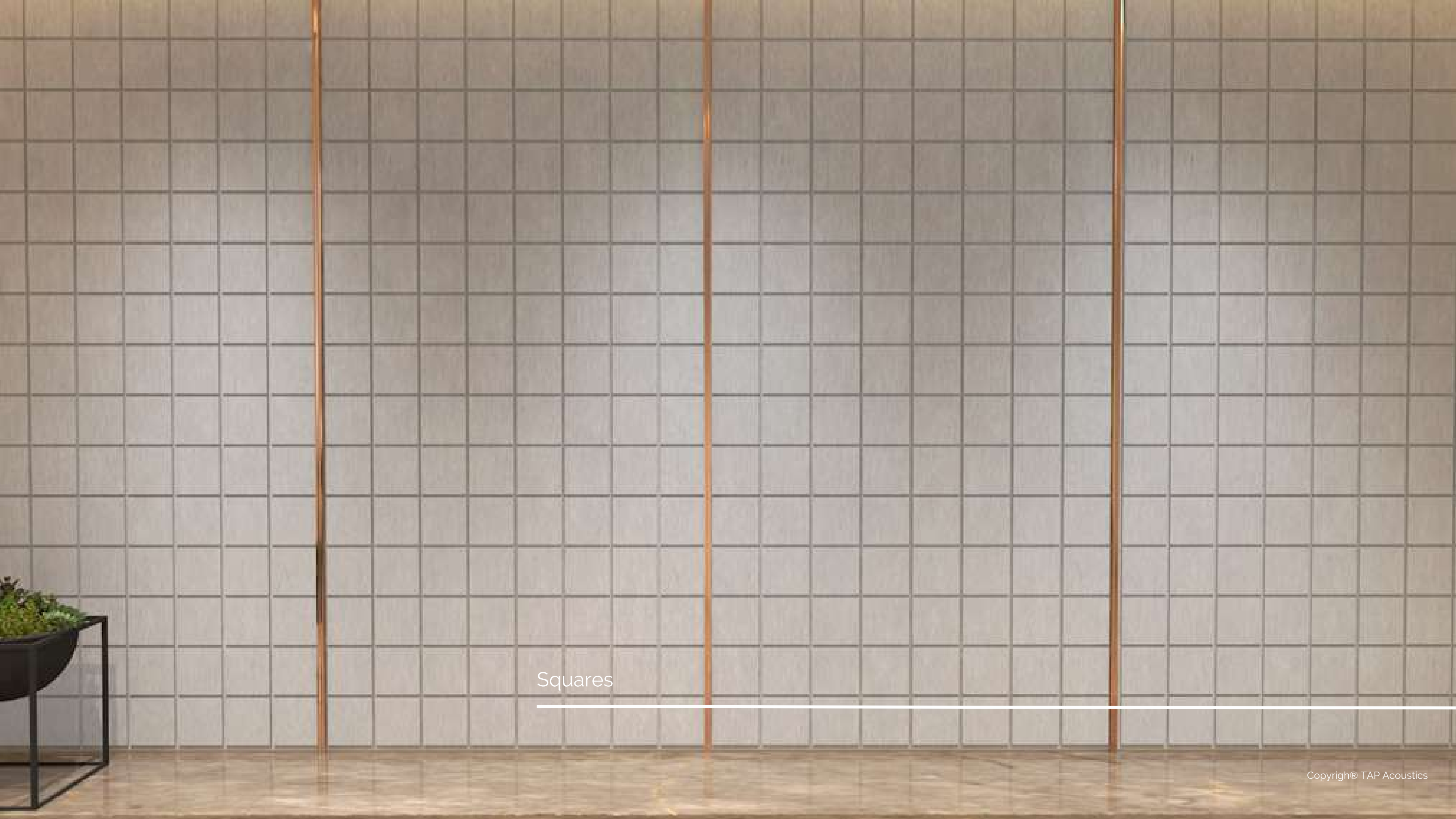

Squares

---





Oval

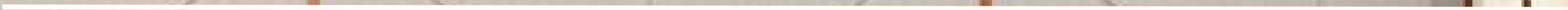

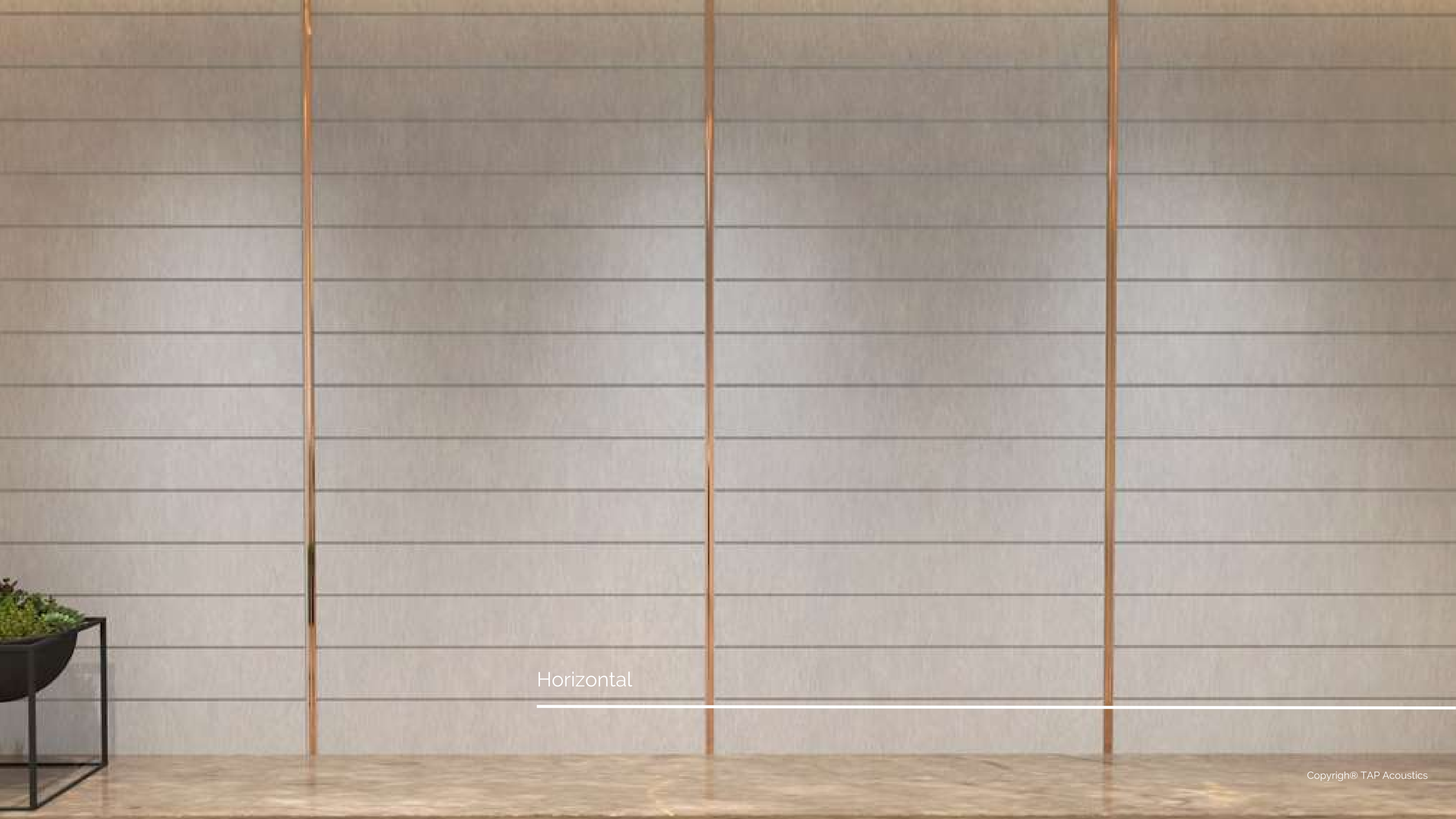

Horizontal

---





Diagonal

---

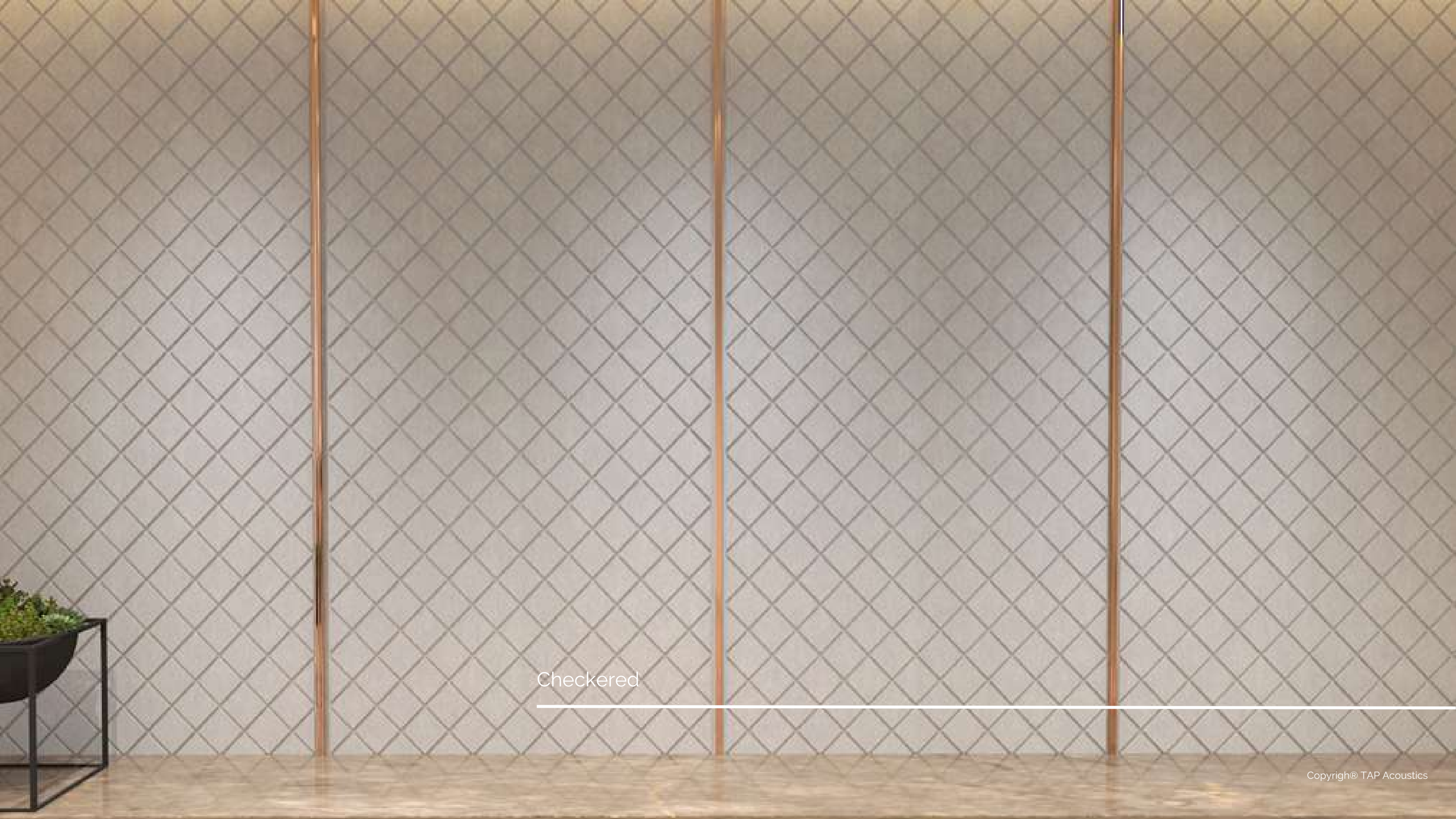

Checkered

---



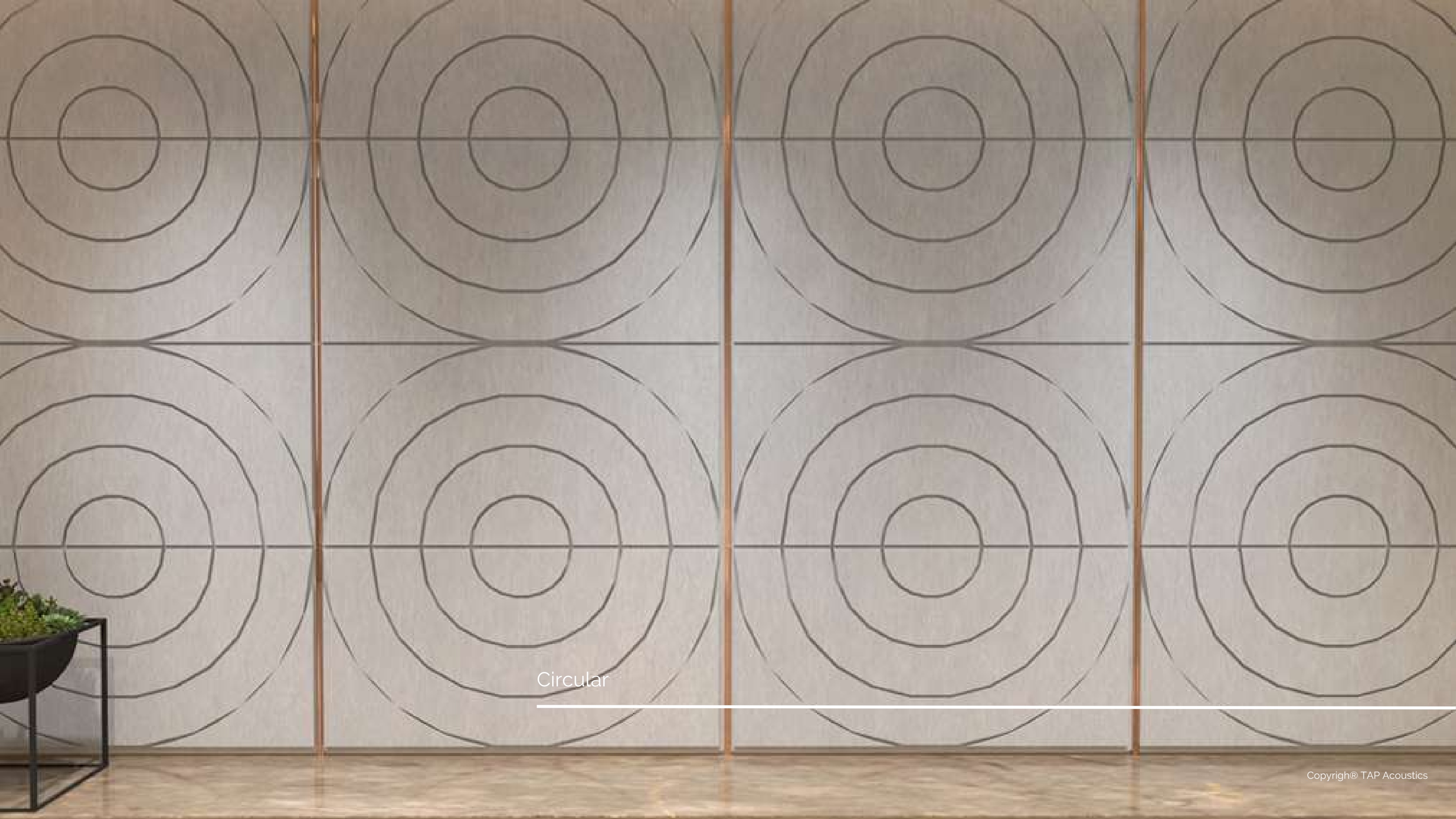

Circular

---





3D TILE



TAP 3D panels are made by moulding fibres into abstract, three-dimensional shapes to provide acoustic absorption across a wide frequency range. This product range, through its endless design customisation, adds both visual impact and decorative value to various interior spaces.

---





CIRCLE



MUTE

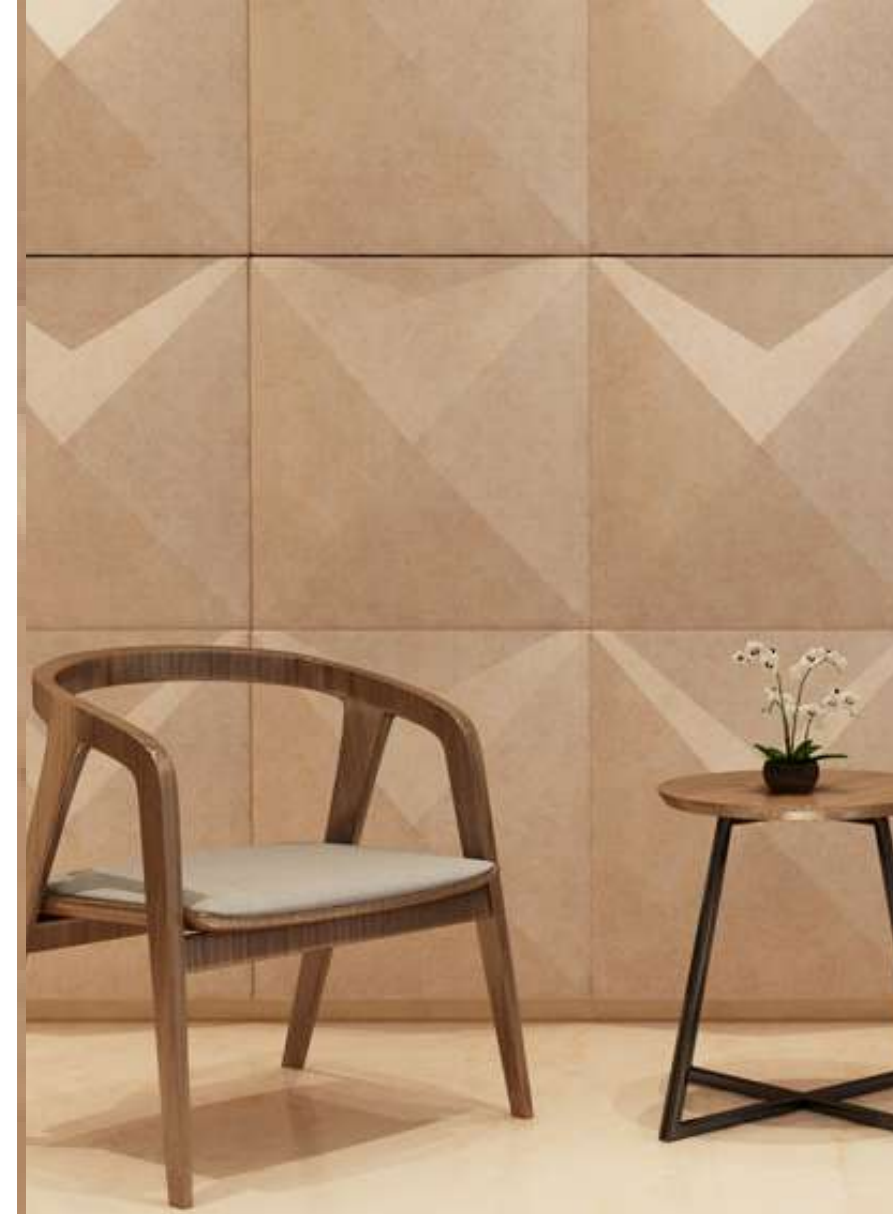

TILED



WAVE

# 3D TILE PATTERNS

[Use 3D Style Selector](#)





Circle



Mute





Tiled

---



Wave





**EMBOSSSED**



TAP® Embossed Series combines cutting-edge design with sustainability and high acoustic performance, embracing a trend towards tactile surfaces and subtle three-dimensional textures. This product category boasts of avant-garde embossed surface patterns, ranging from assorted organic motifs to animal skin textures which adorn the surface of your interior wall.







**LASER**

With its' high-performance sound absorption quality and expansive range of patterns and colours, TAP® Laser Series is sure to meet your requirements. Whether you want to subdue the chitter-chatter across the other end of the room or simply seek better privacy around your work desk, our laser-cut methodology can help you achieve your design vision.





# CEILING

---

Your space deserves a ceiling that is both functional and visually stunning. That's where we come in -TAP® provides the perfect solution for achieving exceptional sound quality in any environment. With **a range of options available, including standard grid, ceiling baffles, and cloud ceiling designs, TAP® panels can be customized to fit the needs of any space.** Whether you're looking to create a more productive workspace or enhance the ambiance of a restaurant or hotel, we can help you achieve your goals. Choose from a variety of designs to create a unique and impactful ceiling that will make a lasting impression on your guests.



GRID



TAP® Grid Ceiling Tile is the most basic, durable, high performing acoustic tile that conforms to the typical ceiling standards of any commercial space and can be easily fitted within regular grid systems. Unlike other grid tiles which have a tendency to break easily, this product, while being lightweight, is strong enough to prevent any form of chipping, cracking or breaking. Furthermore, you can choose from a wide range of customisable textures and colours - which allow you to turn any solemn looking space into a colourful one.







BAFFLE



TAP® Baffle Ceilings effectively control any unwanted acoustic issues including drifting noise and echo. They can improve speech clarity and make communication easier, particularly where spaces such as classrooms, workstations, conference rooms, auditoriums are concerned. Baffle ceilings create a feeling of spaciousness because of the way they are installed - and can be preconfigured to make custom designs. With TAP® Baffles, you can control the height, spacing, and placement of each individual component which integrates well with the interior spaces via adjustable channel and clip system.







# INTERSECTING

---



TAP® Intersecting Ceiling Panels are an assortment of hanging acoustic sculptures made of an acoustic fin grid that can have both a delightful abstract form or evenly spaced and calculated form. Unlike mainstream parallel baffle systems, TAP® Intersecting Panels absorb sound more effectively in interior spaces by covering a greater surface area at each intersection.



# FLOATING





TAP® Floating Ceiling is a cloud-ceiling system that offers quality acoustic and aesthetics. As both a timeless design feature and a high-performance acoustic absorber, this cloud ceiling holds space with its simple forms and clean lines. TAP® Floating Ceiling Panels are highly durable and lightweight and add a distinct design feature to any modern open ceiling spaces - ranging from offices to restaurants where both form and functionality matter. With the adjustable suspension system, you can easily control the hanging height, which gives you the ability to target multiple frequency levels within the space.



# ACOUSTIC LIGHTING

---

Numerous studies have established that light and room acoustics play a vital role in enhancing productivity, human interaction, and overall well-being. In light of this, we have developed **a diverse collection of hanging lights and chandeliers that seamlessly integrate light, acoustics, and aesthetics.** TAP® acoustic lighting range is not only aesthetically pleasing but also **effectively reduces background noise in open spaces, conference rooms, meeting rooms, and lobbies.**





# CHANDELIER



Make a bold design statement with our acoustic chandelier solution, which can be used as a striking singular piece or clustered together for added romance. Its versatile design makes it perfect for a variety of settings, including offices, restaurants, lounges, hotels, and more. Choose from our bright range of colors to add a pop of color to your space while enhancing its acoustic properties. Despite its lightweight feel, the felt body boasts a large surface area for superior sound absorption. For large spaces with high ceilings, combining different suspension heights can help prevent sound from traveling and create a more comfortable atmosphere.

---

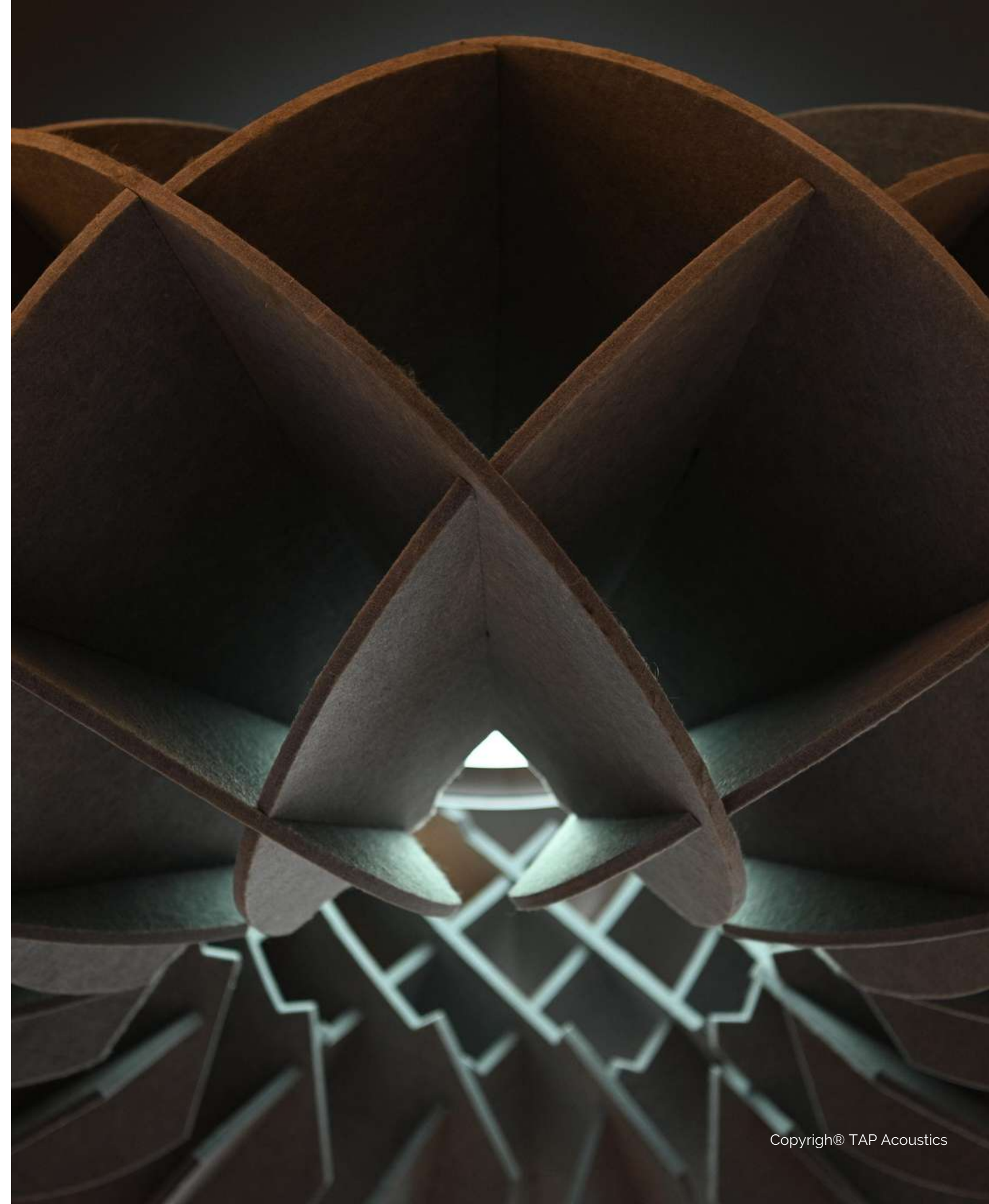



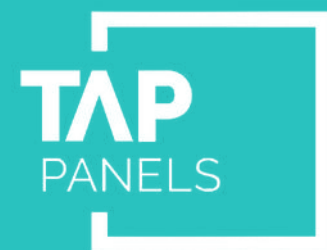

# TECHNICAL INFO

---

# TECHNICAL

## INFO



Motivated by a strong sense of collaboration with individuals and organizations promoting and selling TAP® products, our dedication extends to supporting architects, contractors and sales representatives in achieving success in their enterprise.

This brochure is specifically crafted to aid our product users in effectively communicating the exceptional attributes of TAP® Acoustics' collections, enabling them to offer valuable advice to end users, architects, and developers and to optimize their business operations.



# PHYSICAL

SPECIFICATION

<b>Product Name.</b>	Tmes Acoustic Panel (TAP®)
<b>Manufacturer.</b>	Times Fibrefill Pvt. Ltd.
<b>Origin.</b>	Kolkata, India
<b>Colour.</b>	36 Solid Colours
<b>Composition.</b>	100% PET (60% Recycled)
<b>Panel Dimensions.</b>	2440 mm (+/-5%) x 1220 mm (+/- 5%)
<b>Density.</b>	200 kg/m <sup>3</sup> (+/-10%)
<b>Thickness.</b>	9mm   12mm   24mm (+/- 10%).

**Colour Fastness to Light.**

ISO 105-B02- 1944 Rating: 6-7  
AS 2001.4.21 - 1970 Rating: 6-7

**Fire Test.**

ASTM E84 CLASS A

**Surface Care.**

Blot excess spills from material quickly.  
Wipe with a damp cloth vacuum regularly.

**VOC Emission.**

ASTM D5116 Rate:<0.2 mg/m2/hr (7 Days)

**Environmental.**

IGBC | GRS Certified Manufacturer



## **TAP® 9MM / 12MM / 24MM Acoustic Panel**

**Final Assembly:** Kolkata, WB

**Life Expectancy:** 50 Years

**End of Life Options:** Salvageable / Reusable in its Entirety,  
Recyclable (100%)

### **Ingredients:**

Polyethylene Terephthalate: PET; Antioxidant 1076:  
Benzenamine, 4-(1-Methyl-1-Phenylethyl)-N-[4-(1-Methyl-1-  
Phenylethyl)Phenyl]-, Benzenepropanoic Acid, 3,5-Bis (1, 1-  
Dimethylethyl)-4-Hydroxy-, Octadecyl Ester, Octadecanamide,  
N, N'-1,2-Ethanediybis-, Stearic Acid, Titanium Dioxide

**DECLARE**

---

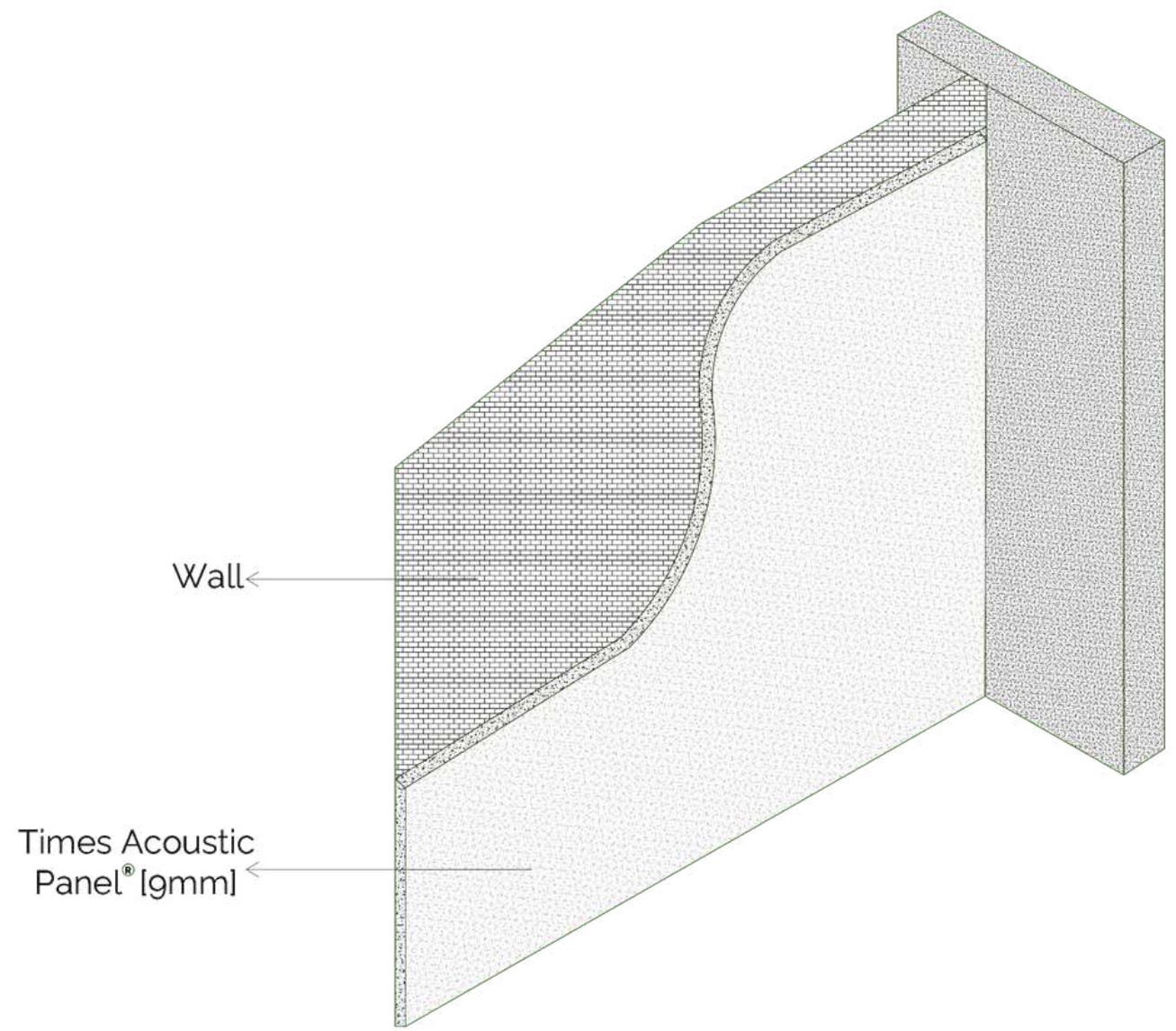

**NRC Value: > 0.40**

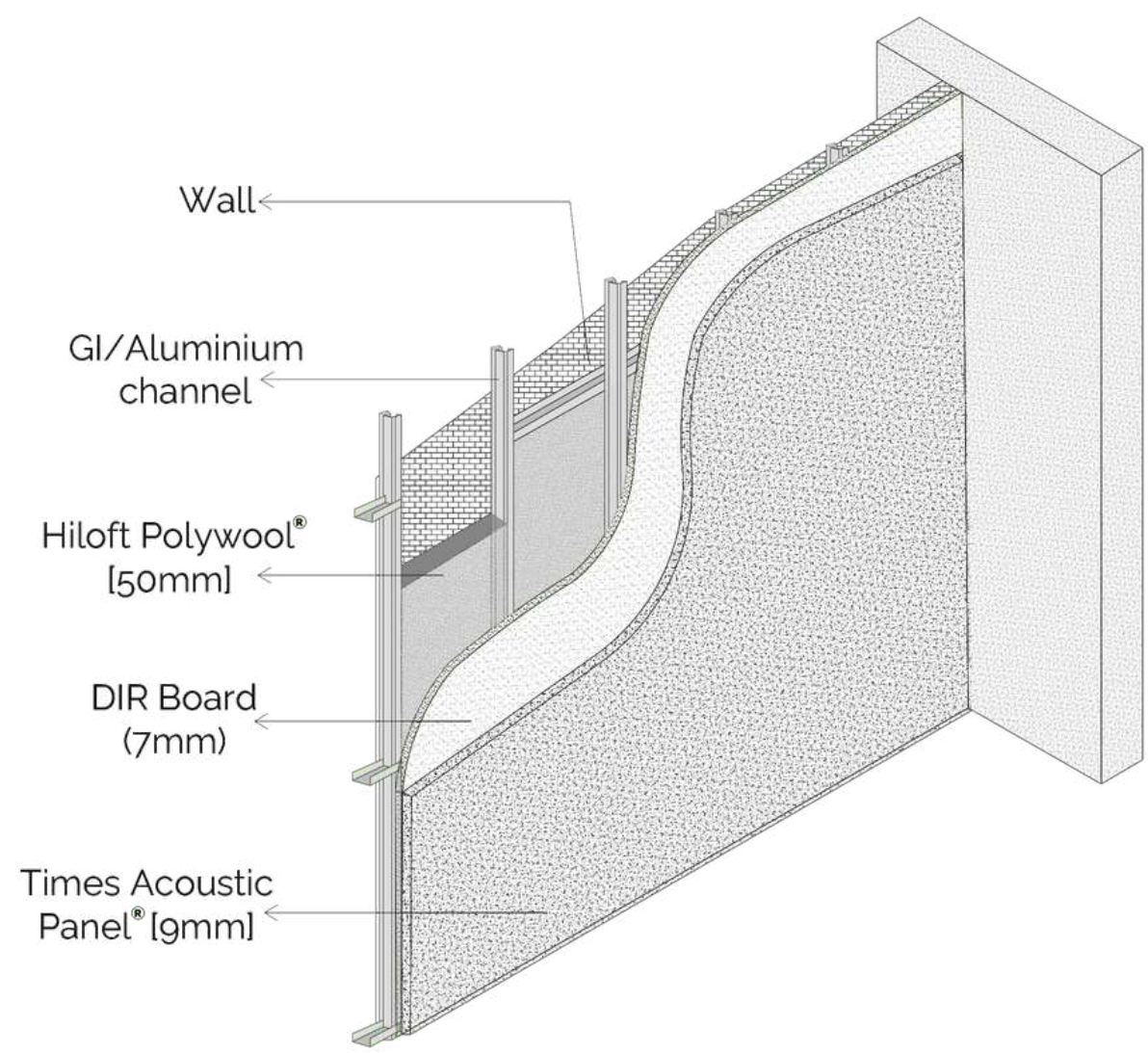

**NRC Value: > 0.90**

9MM Panel Specification

---



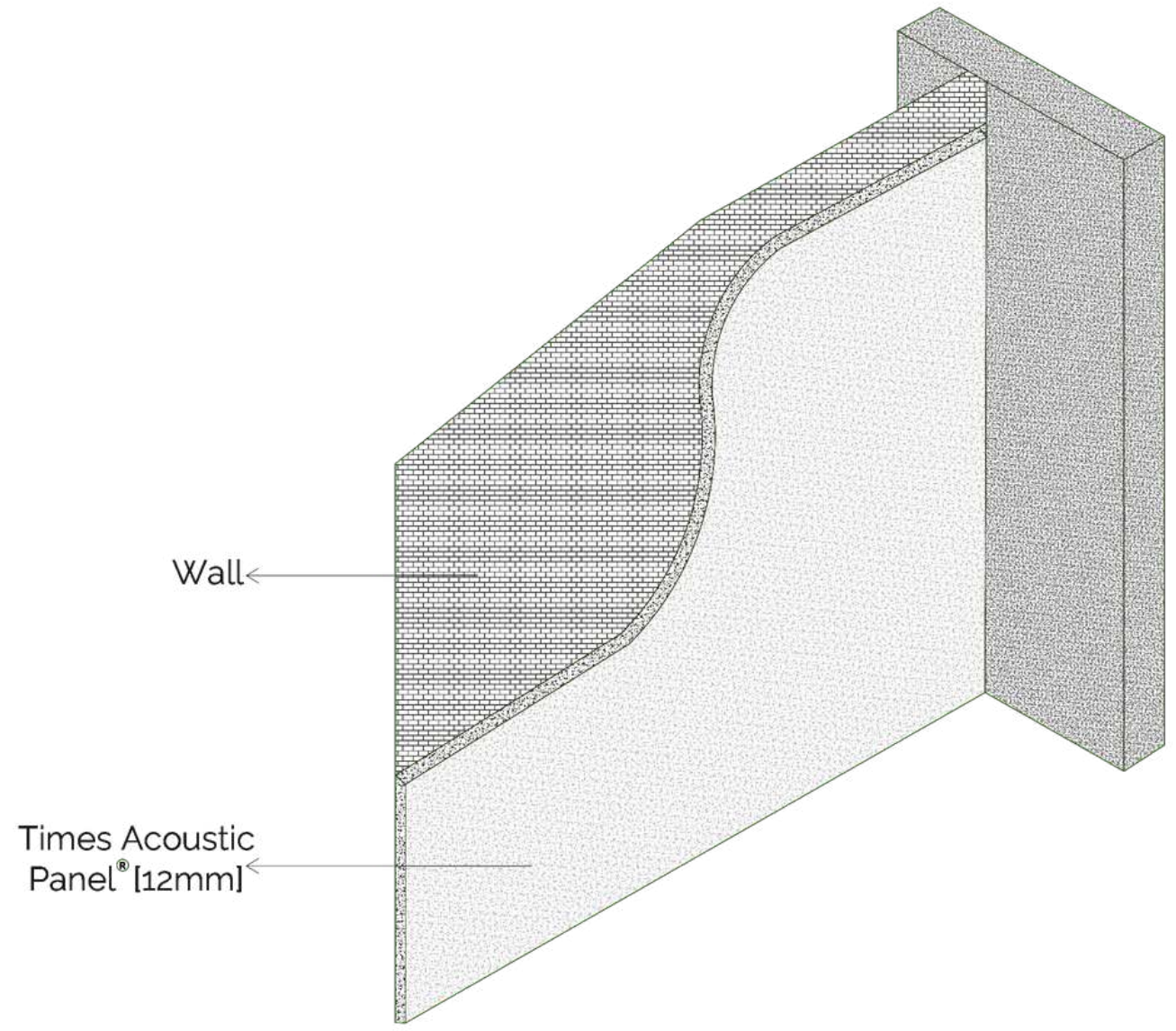

**NRC Value: > 0.45**

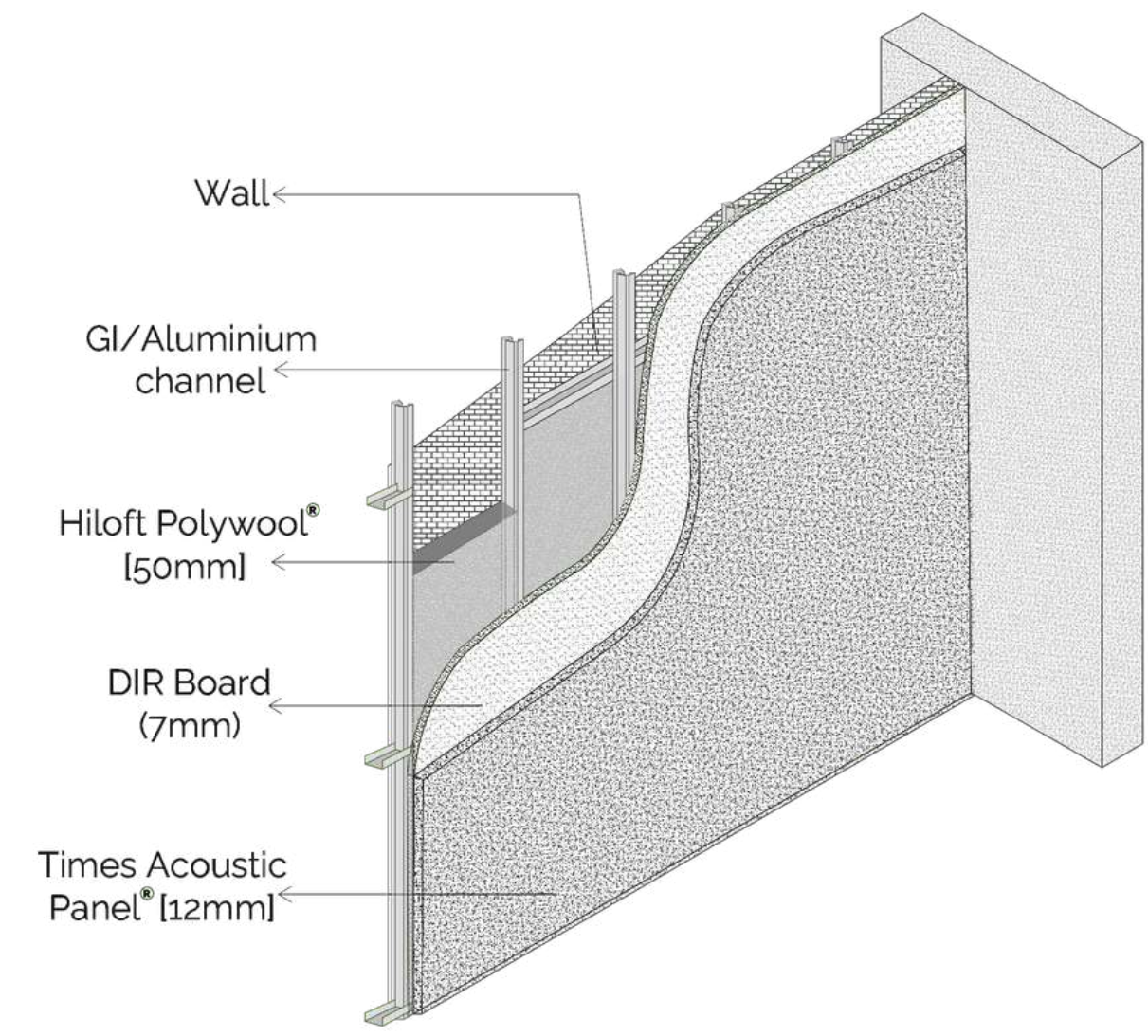

**NRC Value: > 0.95**

12MM Panel Specification

---



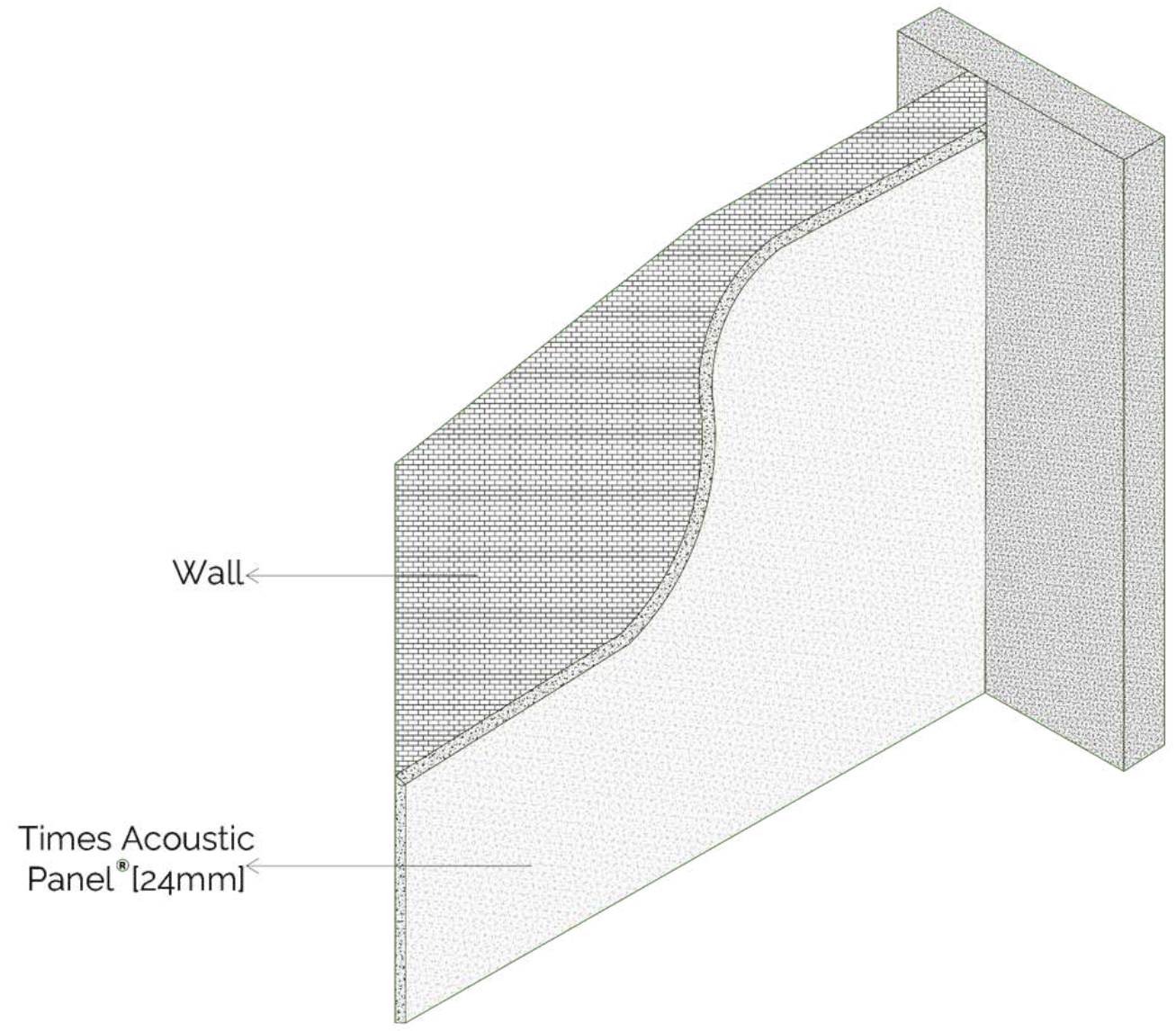

**NRC Value: > 0.60**

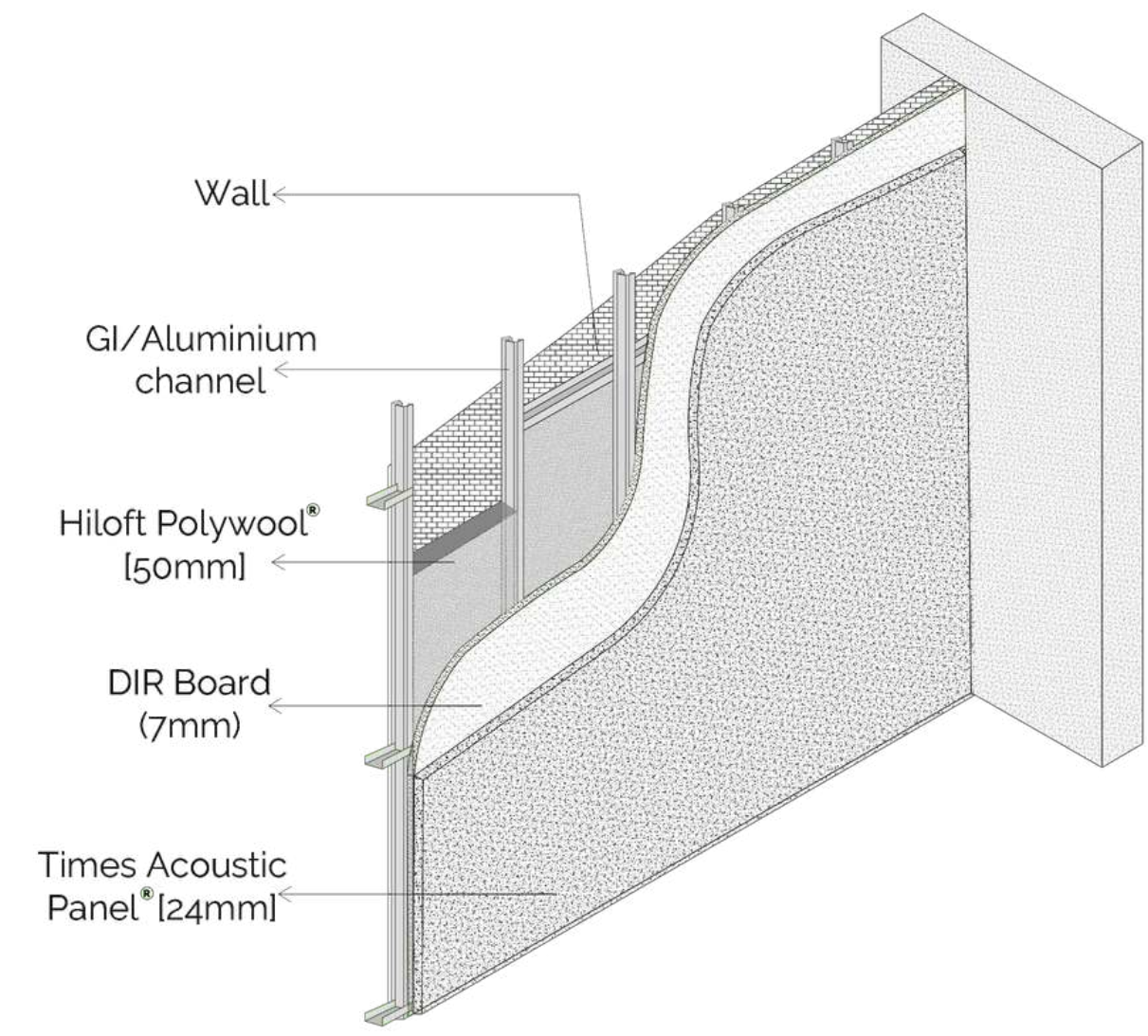

**NRC Value: > 1.00**

24MM Panel Specification

---



# SPECIFICATION

## KNOW-HOW

### **Direct**

Providing and fixing of 9mm / 12mm / 24mm thick Times Acoustic Panel (TAP®) with class A fire rating as per ASTM E84, directly pasted on walls/ply surface using suitable adhesive. The surface should be free of crack, dust and dirt. Design to be done as per drawings issued by Architect / Interior Designer / Engineer in charge.

### **Panelling**

Providing and fixing wall panel using Times Acoustic Panel (TAP®) of 9mm / 12mm / 24mm thick with class A fire rating ASTM E84. Framework can be made with GI or Aluminium Channel of 50mm with Hiloft Polywool® of 50mm / 20kg/m<sup>3</sup> density fitted inside the frame. On outer side 7mm thick DIR board is fixed and Times Acoustic Panel (TAP®) of 9mm / 12mm / 24mm is pasted on the top of the board using suitable adhesive as per design / drawings issued by Architect / Interior Designer / Engineer in charge.





**CONNECT**  
WITH US

**Times Fibrefill Pvt. Ltd.**

Module 28, 13th Floor, Tower 1, Bengal Eco Intelligent  
Park, EM 3, Sector V, Salt Lake City, Kolkata, WB, 700091

**P.** +91 98756 33770 / 33773

**E.** [tap@timesfiberfill.com](mailto:tap@timesfiberfill.com)

**W:** [www.tapacoustics.com](http://www.tapacoustics.com)

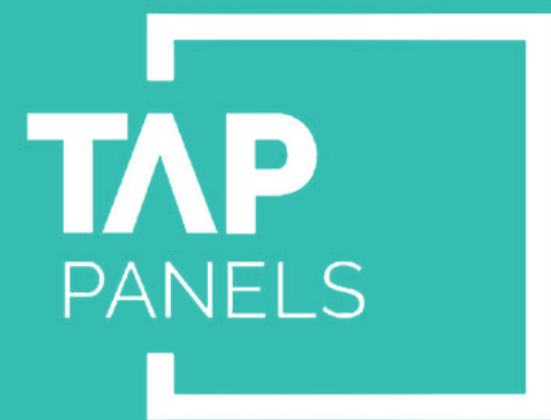

---

[www.tapacoustics.com](http://www.tapacoustics.com)